

Hydraulic and Manually- actuated Monitor Valve Normally- Open version Model 77-x-MO\RC(N.O.) [x= size in inches]

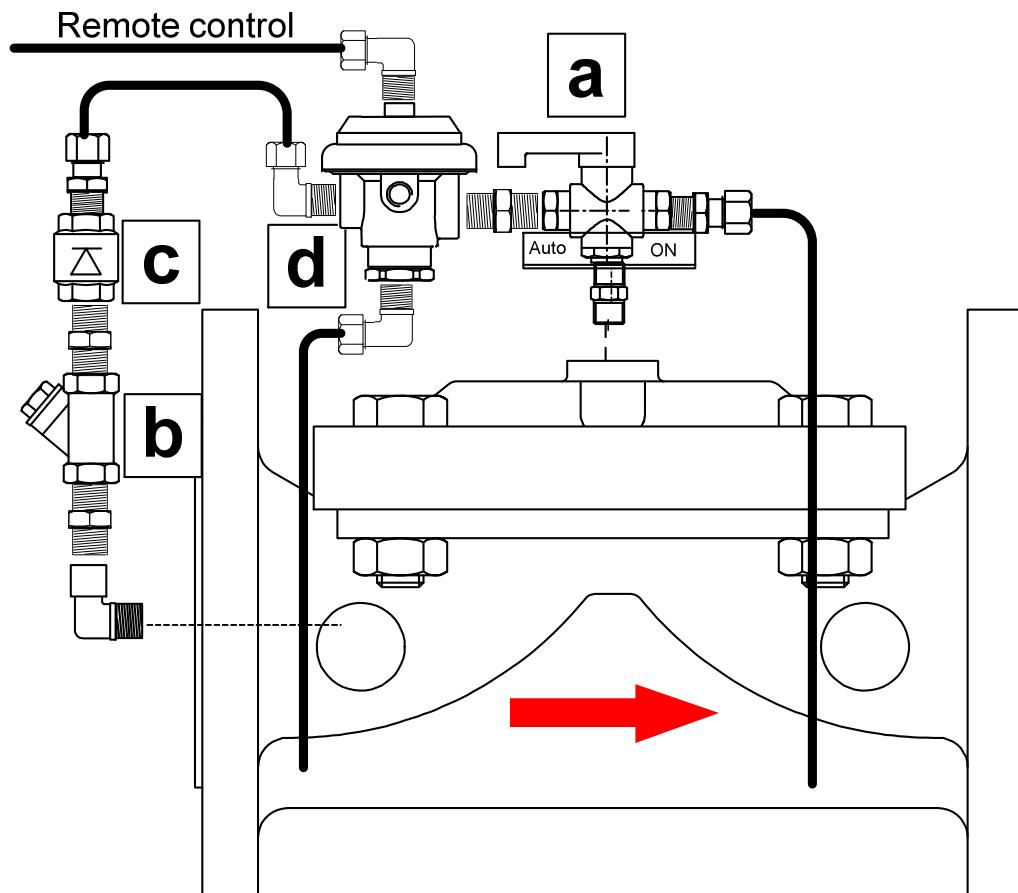

Main Components

- a. Manual activation valve
- b. Control Filter
- c. Check valve
- d. 3/2 Hydraulic Relay



CONTROL VALVE TECHNICAL SPECIFICATIONS

CONTROL VALVE	1. Model	77-x-MO\RC(NO)	
	2. Type	Straight flow, weir type.	
	3. Description	A hydraulic and manually controlled valve. The valve will maintain a closed position and will open when the activation selector valve, assembled on its bonnet is turned to "on" position or when the remote control pressure is released.	
	4. Sizes	See table next page	
	5. Kv \ Cv	See table next page	
	6. Length	See table next page	
	7. Weight	See table next page	
SERVICE CONDITIONS	8. Pressure	1.5 – 16 bar	
	9. Flow	See table next page	
	10. Temp.	0 – 80° C \ 32 - 176° C	
	11. Fluid type	Water	
PARTS & MATERIALS	12. Main valve	Body & Cover: Ductile Iron GGG-40	Diaphragm: Reinforced NR
		Spring: SST 302	Indicator: N/A
	13. Pilot	Model: - 66-212	
		Body & Cover: Brass	Plug, Seat & Spring: SST
		Needle bolt: N/A	Diaphragm: NR
	14. Accessories	Control Filter	Type: "Y" external
			Screen: SST
			Body & Housing: Brass
		Cock valves	Ball: Brass
			Body: Brass
		Solenoid	Type: None
	Rating:		
	Enclosure:		
	Body:		
Orifice:			
Actuation:			
NOTES	<ul style="list-style-type: none"> Copper tubes and brass fittings 		

The service condition information contained within this document is based upon information received from the client or their representative for a specific project. The recommendations specified in this document are based on this information and do not represent any obligation on the part of *Dorot*.
The Recommendations herein are not to be constructed as recommendations for any other project. Complete recommendation must include a *Dorot* approved drawings.

Valve model 77 – Technical data

VALVE SIZE		Flow factor		Maximal Flow					
				Continuous		Intermitent		Momentary	
mm	inch	Kv	Cv	m ³ /hr	gpm	m ³ /hr	gpm	m ³ /hr	gpm
50	2	95	110	40	175	60	260	110	485
80	3	170	200	90	400	130	570	245	1080
100	4	220	260	160	705	230	1010	435	1920
150	6	600	700	350	1542	510	2243	955	4205
200	8	800	935	480	2115	700	3080	1310	5770
250	10	1250	1460	970	4300	1410	6250	2640	11730

VALVE SIZE		L		H		R		W		Weight	
mm	inch	mm	inch	mm	inch	mm	inch	mm	inch	Kg	Lbs
50	2	200	7.87	166	6.54	85	3.35	166	6.54	7.7	17
80	3	285	11.22	200	7.87	105	4.13	200	7.87	18.2	40.1
100	4	305	12.01	230	9.06	110	4.33	230	9.06	24	53
150	6	390	15.35	314	12.36	145	5.71	300	11.81	49	108
200	8	460	18.11	400	15.75	170	6.69	365	14.37	86	190
250	10	535	21.06	445	17.52	205	8.07	440	17.32	125	276

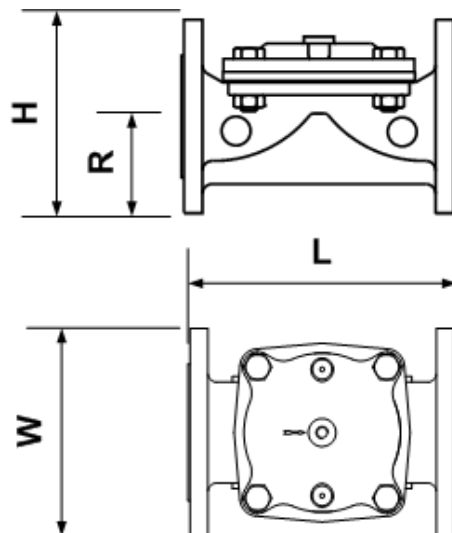

Valve model 77

Component no.	Description	Material	Details
1	Coated body	Cast iron (mod. 47) Ductile iron (mod. 77) Cast Bronze (mod. 87)	
2	Coated bonnet	Cast iron (mod. 47) Ductile iron (mod. 77) Cast Bronze (mod. 87)	
3	Diaphragm	Reinforced NR (optional: Nitrile, EPDM)	
4	Spring	SST 302	
5	Spring disk	Plastics	
6	Bolt	Coated steel	5/8"NFx2 1/2"
7	Nut	Coated steel	

